

AMPLETEK Cable accessories - Medium Voltage

► Company Brief Introduction



Guangdong AMPLE Technology Co.,Ltd., is a large-scale manufacturer with the integration of research, production and marketing of M.V.& H.V. cable accessories. The company mainly business in medium/high-voltage cable plug parts, GIS inner cone plug-in terminals as well as screen zinc-dioxide arresters, covering voltage levels from 6kV to 40.5kV. The plug parts ranging from 24kV to 36kV have passed the European Electrical Authority test “KEMA test”. We based on scientific research, attached importance to the market, and stick to the integrated manufacturing sales and service pattern---”High quality product plus high-quality technical service”. Provide excellent and complete cable branch power distribution resolutions and all the concerned product service for medium/high-voltage power distribution customers both at home and abroad.



▶ 12-24kV 630A Screen Front connector



Type: AQT3 12-24/630KD/□

1. Screen Front/Rear connector is suitable for 20kV Electric Distribution System, Cable Branch Unit, Ring Main Unit and Pad-mounted transformer, etc. . It assures product can supply electricity for branches.
2. Suitable for fully-submersible connection of size $\phi 46/\phi 56/91.5/M16$ bushing (Meet for En50180 and En50181).
3. Apply to 12/20kV、18/30kV XLPE cable , cable cross section is 35-400mm².
4. KEMA certificate passed.



Type: AHT3 12-24/630KD/□

Characteristics

1. Fully-insulated, fully-submersible and fully screened product.
2. The distance between the center of assembled front and rear connector is 100mm. Not only meet the mounting space requirement of inflatable type ring main unit but minimized the structure dimension of distribution branch box.

1. Cable
2. Cable adapter
3. Earthing wire
4. Front connector body
5. Bushing
6. Screen cover
7. Un-screen insulating plug
8. Bolt
9. Copper linking rod
10. Compression lug
11. Rear connector body

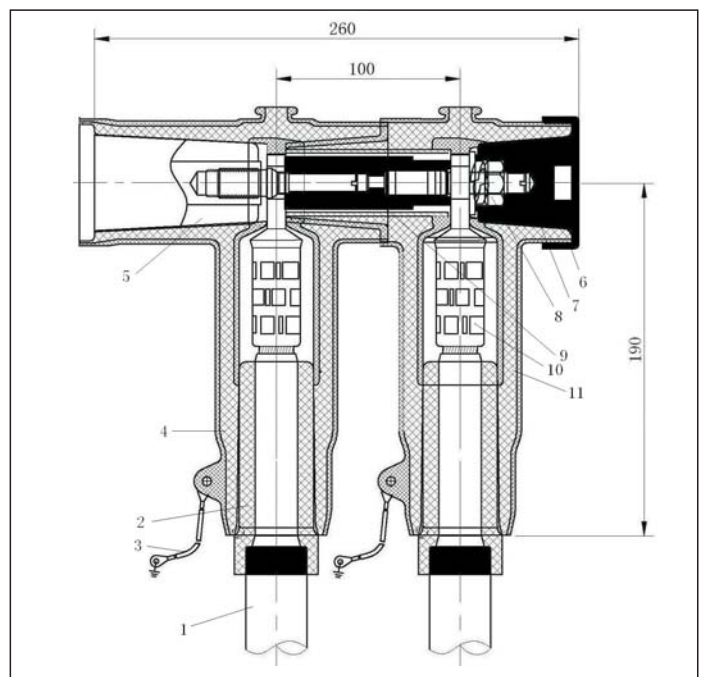

▶ 24kV 250A Elbow / Straight connector



Type: AZT 12-24/250/□



Type: AZC 12-24/250/□

1. Elbow connector and straight connector are suitable for the outline of Ring Main Unit and Transformer.
2. Rated current : 250A
3. Apply to 12/20kV、18/30 XLPE cable, the cable cross section is 35–120mm².
4. Special fixing structure makes the spring compress come true.

Characteristics

1. Fully-insulated, fully-submersible and fully-screened.
2. The compress device guarantees the reliable using.
3. Compared with other device, the structure dimension is more compact.
4. No minimum phase clearance requirements.
5. Mounting can be vertical , horizontal , or any angle in between

1. Cable
2. Earthing wire
3. Semi-conductive tape
4. Bolt
5. Compression lug
6. Nut
7. Elbow /Straight connector body
8. Compression board
9. Copper linking rod

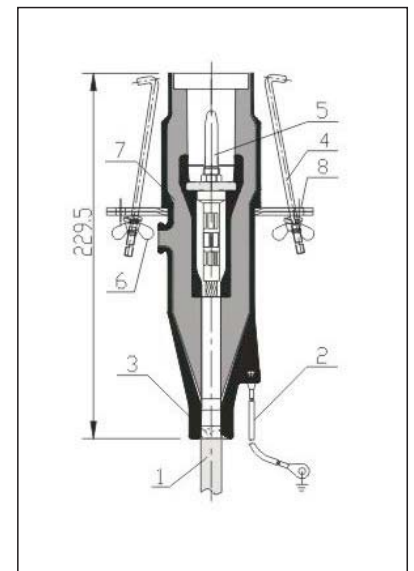
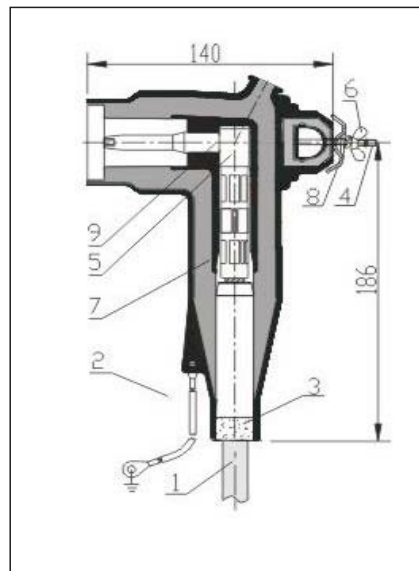

▶ 36kV 630A Front / Rear connector



Type: AQT3-36/630KT/□

1. Screen Front/Rear connector is suitable for Electric Distribution System, Cable Branch Unit, Ring Main Unit and Pad-mounted transformer, etc. . It assures product can supply electricity for branches.
2. Suitable for fully-submersible connection of size $\phi 46/\phi 56/91.5/M16$ bushing (Meet for En50180 and En50181) .
3. Apply to 18/30kV XLPE cable , and cable cross section is 35-400mm².
- 4 . Type test passed.



Type: AHT3-36/630KT/□

Characteristics

1. Fully-insulated, fully-submersible and fully screened product.
2. It can balance the electric field intensity, high performance, small space, special structure design.
3. It's easy for installation, higher tolerance.
4. Excellent stress control, compact design, long shelf life.

1. Cable
2. Cable adaptor
3. Earthing wire
4. Front connector body
5. Bushing
6. Screen cover
7. Screen insulating plug
8. Bolt
9. Copper linking rod
10. Compression lug
11. Rear connector body

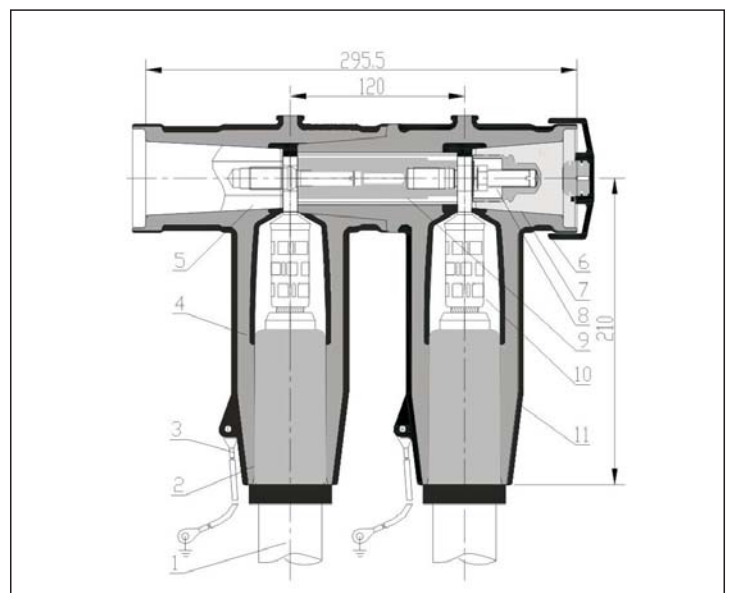

▶ 24/36kV 400A Deadbreak Elbow connector



■ AZT-24/400/□

■ AZT-36/400/□

1. Deadbreak Elbow connector is for the connection of polymeric cable to transformers, Switchgear, motors and other equipment with a premoulded separable connector.
2. For Indoor and outdoor installations.
3. Apply to 18/30kV XLPE cable, cable cross section is 35-400mm².
4. Rated voltage : 24kV / 36kV
5. Rated current: 400A

Characteristics

1. Provides a fully screened and fully-submersible separable connection when mated with the proper bushing or plug.
2. Built-in capacitive test point allows for an easy check of the circuit status or installation of a fault indicator.
3. Not minimum phase clearance requirements.
4. Mounting can be vertical, horizontal, or any angle in between,

▶ Electrical Ratings

Description	AZT-24/400	AZT-36/400
Max. System voltage(U _m)	24kV	36kV
Impulse	125kV	170kV
A.C. withstand voltage (5min)	54kV	81kV
Continuous current	400A	400A
Overload (8hrs Max.)	600A	600A
Short circuit withstand, 1sec.	18kA	18kA

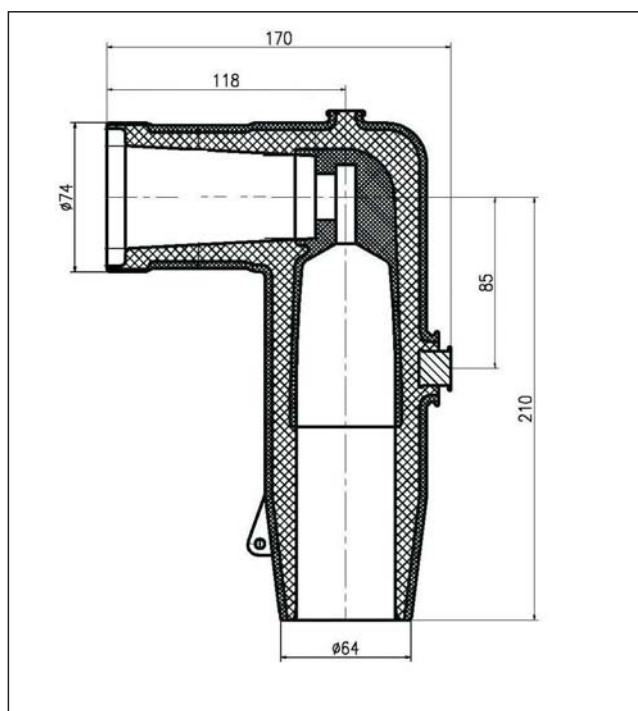

▶ 15kV Rear connector w/arrester



Type: AHY5WZ7-17/45(50)

1. Rear connector w/arrester protects electric apparatus from lightning and over-voltage.
2. Arrester is adopted special explosion-protective separable device.
3. The arrester can keep in good operation under the condition of broken because of longtime aging or thunder lightning strike.
4. Protect the arrester from explosion or permanent earthing fault.
5. Guarantee the grid running safely.
6. Suitable for AQT3-15/630KD Front connector .

Connector w/arrester performance parameter

Description	AHY5WZ7-17/45(50)
System nominal voltage	10kV(r.m.s)
Rated voltage	17kV
Continuous operation voltage	13.6kV
5kA lightning impulse current residual voltage	45kV
At D.C. 1mA voltage U_{mA}	$\geq 25kV$
Leakage current at D.C. 0.75 U_{1mA}	$\leq 50 \mu A$
2ms Rectangular current withstand	150A
A.C. withstand voltage test for EPDM housing	39kV

▶ 24kV Rear connector w/arrester



Type: AHY5WZ-34/85(34/90)

1. Rear connector w/arrester protects electric apparatus from lightning and over-voltage.
2. Arrester is adopted special explosion-protective separable device.
3. The arrester can keep in good operation under the condition of broken because of longtime aging or thunder lightning strike.
4. Protect the arrester from explosion or permanent earthing fault.
5. Guarantee the grid running safely.
6. Suitable for AQT3-24/630KD Front connector .

Connector w/arrester performance parameter

Description	AHY5WZ-34/85(34/90)
System nominal voltage	20kV(r.m.s)
Rated voltage	34kV
Continuous operation voltage	27.2kV
5kA lightning impulse current residual voltage	≤85kV
At D.C. 1mA voltage U_{mA}	≥48kV
Leakage current at D.C. 0.75 U_{1mA}	≤50 μ A
2ms Rectangular current withstand	150A
A.C. withstand voltage test for EPDM housing	54kV

▶ 35(40.5)kV Rear connector w/arrester



Type: AHY5WZ3-51/134(127)

1. Rear connector w/arrester protects electric apparatus from lightning and over-voltage.
2. Arrester is adopted special explosion-protective separable device.
3. The arrester can keep in good operation under the condition of broken because of longtime aging or thunder lightning strike.
4. Protect the arrester from explosion or permanent earthing fault.
5. Guarantee the grid running safely.
6. Suitable for IEC AQT3-35(40.5)/630KC and IEEE AQT3-35(40.5)/600KB

Connector w/arrester performance parameter

Description	AHY5WZ3-51/134(127)
Rated voltage	51kV
Continuous operation voltage	40.8kV
5kA lightning impulse current residual voltage	134kV
At D.C. 1mA voltage U_{mA}	$\geq 73kV$
Leakage current at D.C. 0.75 U_{1mA}	$\leq 50 \mu A$
2ms Rectangular current withstand	400A(600A)

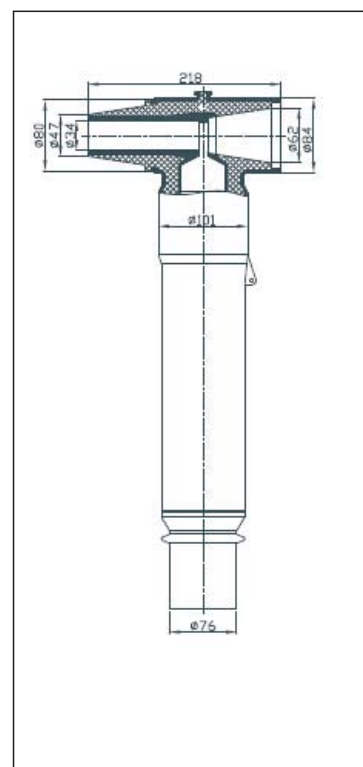

AMPLETEK Cable accessories - Medium Voltage

▶ IEC 35(40.5)kV Screened Front & Rear connector



Type: AQT3-35(40.5)/630KC

1. Suitable for the high voltage electrical apparatus of power plant, power transformer station at or under 40.5kV, such as cable branch box, combination transformer and incoming/outgoing line of GIS system.
2. Fully insulated, fully sealed and fully screened.
3. Adopt advanced back injecting technology, the electric performance reaches the international leading level.
4. More safe and reliable.
5. Little effect by bad weather to mounting condition.
6. Coagulation dew resistant and contaminate proof, free of maintenance.
7. The stress settled with high partial discharge level adopted German technology.
8. The small dimension sufficiently meets the mounting space requirement.
9. Leading provision cable connector in the world.
10. The conductor cross section is 50-630mm².
11. IEC suitable for size $\phi 46 / \phi 56 / 91.5$ mm bushing.



Type: AHT3-35(40.5)/630KC

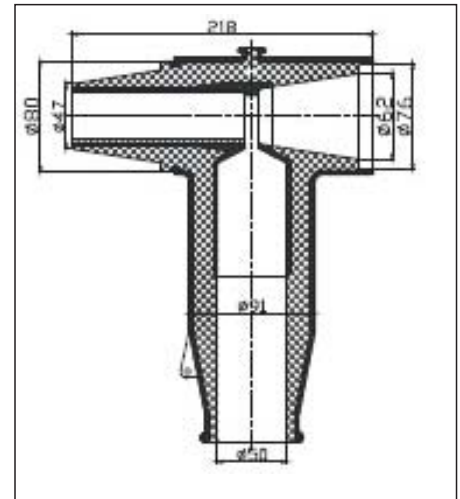
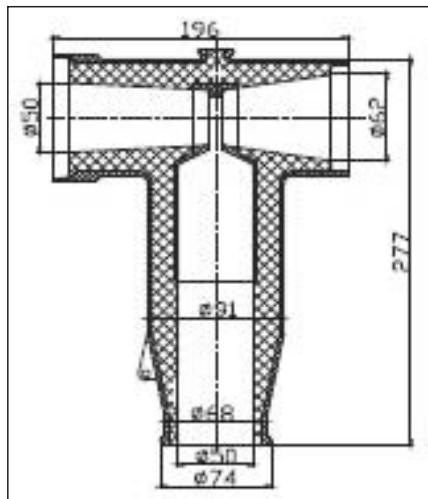

Type: AEB-35(40.5)/630

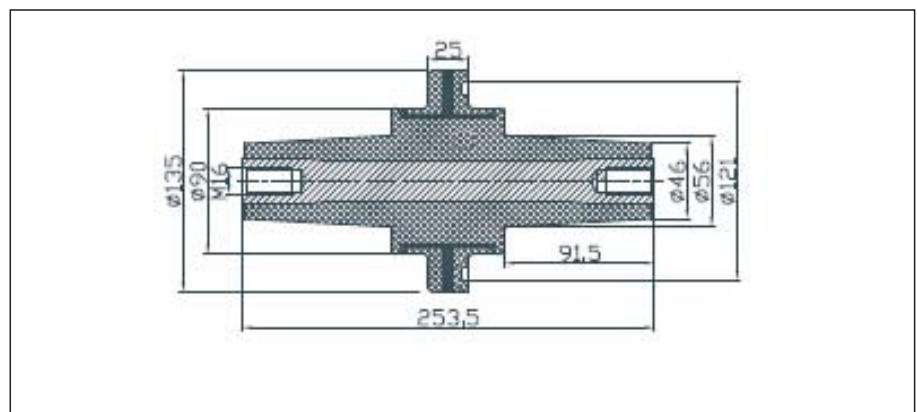

▶ IEEE 35(40.5)kV Screened Front & Rear connector



IEEE Type: AQT3-35(40.5)/600KB

1. Suitable for the high voltage electrical apparatus of power plant, power transformer station at or under 35kV, such as cable branch box, combination transformer and incoming / outgoing line of GIS system.
2. Fully insulated, fully sealed and fully screened.
3. Adopt advance back injecting technology, the electric performance reach the international leading level.
4. More safe and reliable.
5. Little effect by bad weather to mounting condition.
6. Coagulation dew resistant and contaminate proof, free of maintenance.
7. The stress settled with high partial discharge level adopted German technology.
8. The small dimension sufficiently meets the mounting space requirement.
9. Leading provision cable connector in the world.
10. The conductor cross section is 50-630mm².
11. IEEE suitable for size $\phi 40 / \phi 61 / 105$ mm bushing.



Type: AHT3-35(40.5)/600KB

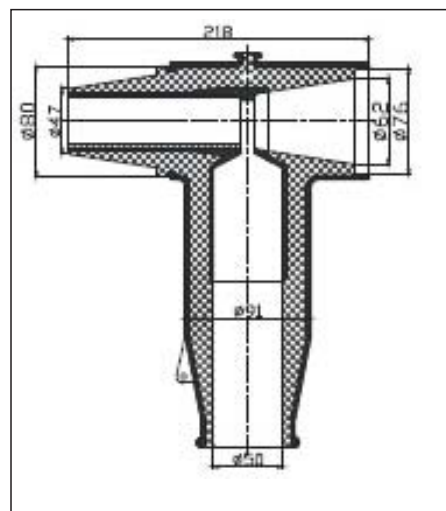
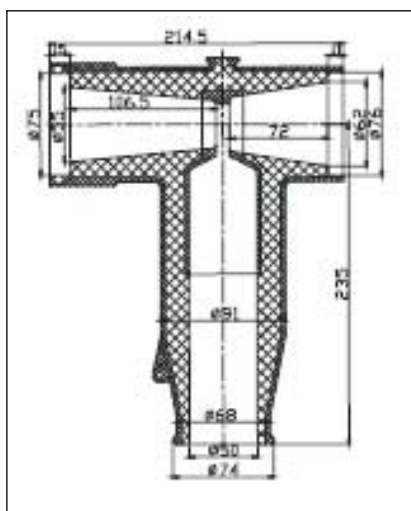

Type: AHB-35(40.5)/630

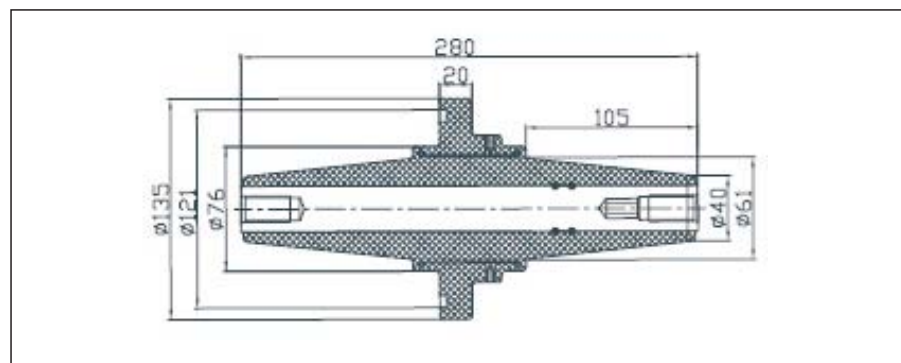

▶ 12-24kV 630A Un-screen Front / Rear connector



Type: AQT2 12-24/630/□

1. Un-screen separable front/rear connector is suitable for cable branch unit, Ring main unit and pad-mounted transformer etc.
2. It is silicone rubber and fully-insulated product.
3. Suitable for fully-submersible connection of size $\phi 46/\phi 56/91.5/M16$ bushing (Meet for En50180 and En50181).
4. Apply to 8.7/15kV、12/20kV XLPE cable, the cable cross section is 35-400mm².

Characteristics



Type: AHT2 12-24/630/□

1. It is fully-insulated, fully-submersible product.
2. Adopt to the advanced injection technology, with high electric performance, more safe and reliable.
3. The distance between the center of assembled front and rear connector is 100mm. Not only meet the mounting space requirement of inflatable type RMU but minimize the structure dimension of cable branch box.

Kit contents:

1. Cable
2. Cable adapter
3. Rear connector body
4. Front connector body
5. Bushing
6. Un-screen cover
7. Un-screen insulating plug
8. Bolt
9. Copper linking rod
10. Compression lug

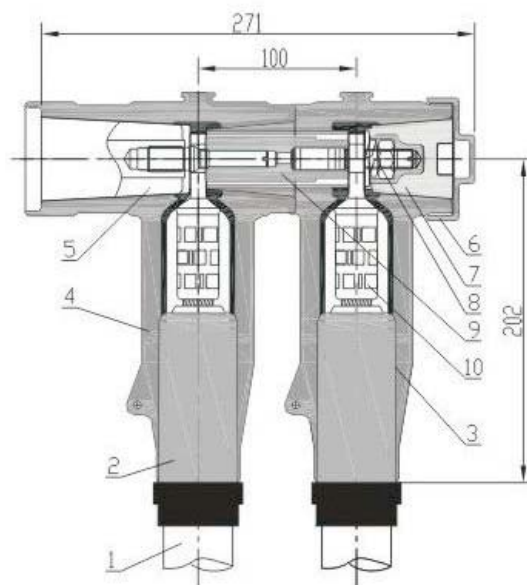

▶ 12-24kV 630A Un-screen T-shape connector



Type: ALJQ-12/630/□

1. Insulated T-shaped pre-molded un-screened silicone bushing boots suitable for 12-24kV Type "C" 630A bushings.
2. It has compact gas-insulated secondary switchgear where the spacing between bushings is significantly reduced.
3. The pre-molded shape ensures optimal/full contact over the entire "C" bushing profile thus improving its ability to eliminate unwanted leakage currents.

Characteristics

1. Quick and easy to install.
2. Easy to remove and re-install.
3. No specialized tools required.
4. Compact profile provides for greater air clearance.
5. Not tracking elastomeric housing offers excellent erosion resistance, dielectric properties and environmental resistance.
6. Suitable to be used with all indoor terminations.
7. No slip /slide off the type "C" .

Kit contents:

1. Un-screen separable connector body
2. Un-screen cover
3. Abrasive paper
4. Silicone lubricant
5. Dielectric cleaning tissue
6. Packing list
7. Installation sheet

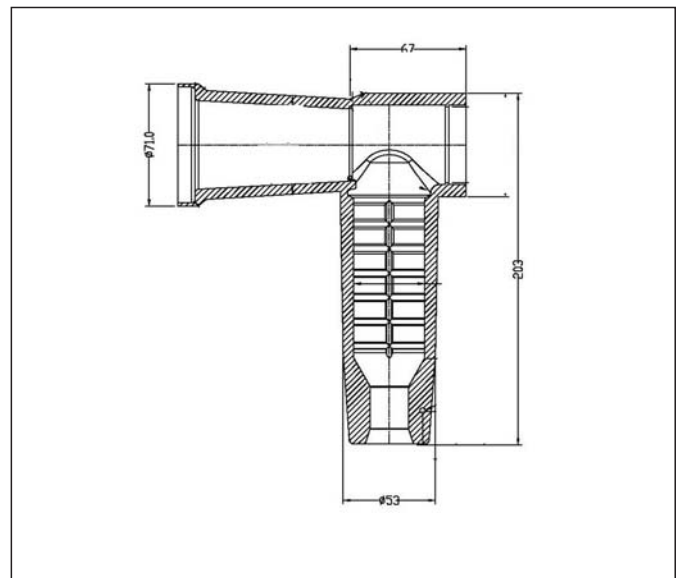

AMPLETEK Cable accessories - Medium Voltage



Type: ALJX-12/□



12-24kV Un-screen Insulating bushing boot

1. Be suitable for operating wet indoor under conditions of ambient temperature and loading.
2. Provide the essential encapsulation of the metallic connection against ambient influences between bushing and cable termination and retains a constant compressive force on the sealing surfaces
3. With tracking resistance EPDM rubber, it minimizes leakage current in wet indoor conditions.
4. Cable cross section : 50mm – 300mm

Characteristics

1. Corrugated centre design allows straight and right angle application.
2. High interface pressure ensures absolute water tightness.
3. No heat required , no specific user skills or craftsmanship required.

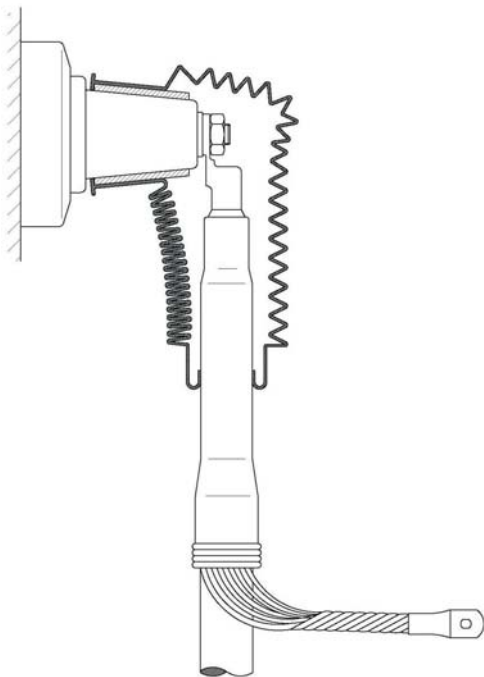

Minimum clearance dimensions for terminations shrouded with insulation bushing boots

Phase to phase clearance (mm)	Phase to earth clearance (mm)	Minimum clearance between bushing boot (mm)
70	30	3

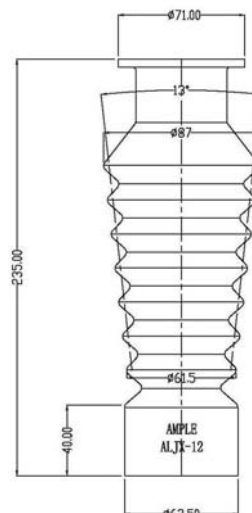

► High voltage Insulation Tubing



1. The insulation tubing is made of EPDM rubber and used for overhead H.V. power transmission system.
2. It is greatly reduced in the accident brought by birds and make sure the safe operation.
3. The insulation tubing will cover any size of cable cross section from 35mm - 500mm .

Insulation Bird tubing

Characteristics

1. Good performance for temperature resistance -40°C.-130°C.
2. Flexible an abrasion resistance.
3. Excellent UV and weather resistant properties.
4. Halogen free
5. Tearing strength $\geq 30\text{N/mm}$
6. Tensile strength $\geq 10\text{MPa}$
7. Elongation ratio $\geq 450\%$
8. Special buckle structure, easy and fast for installation.

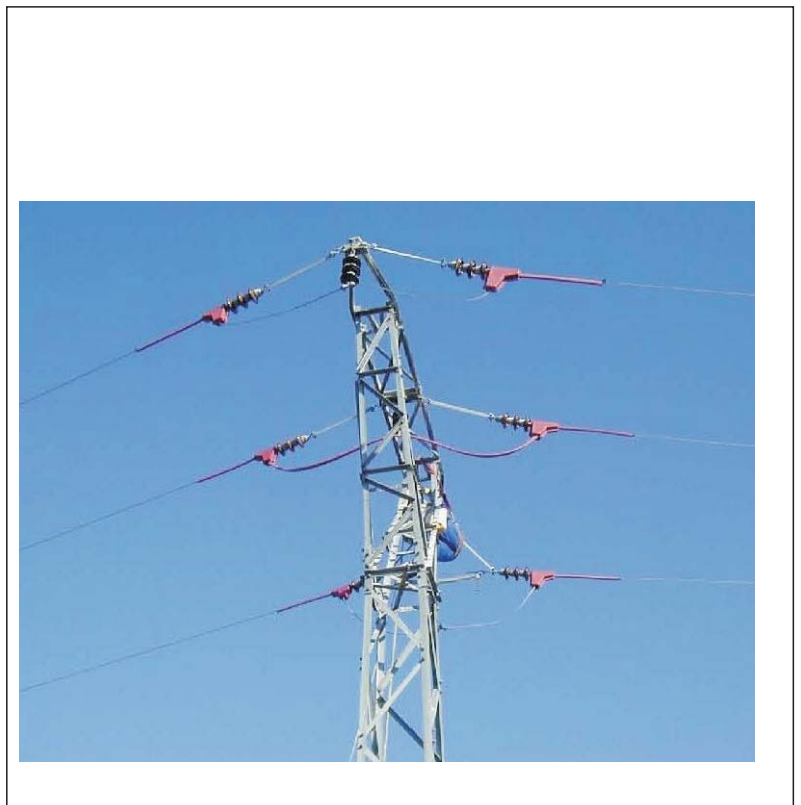
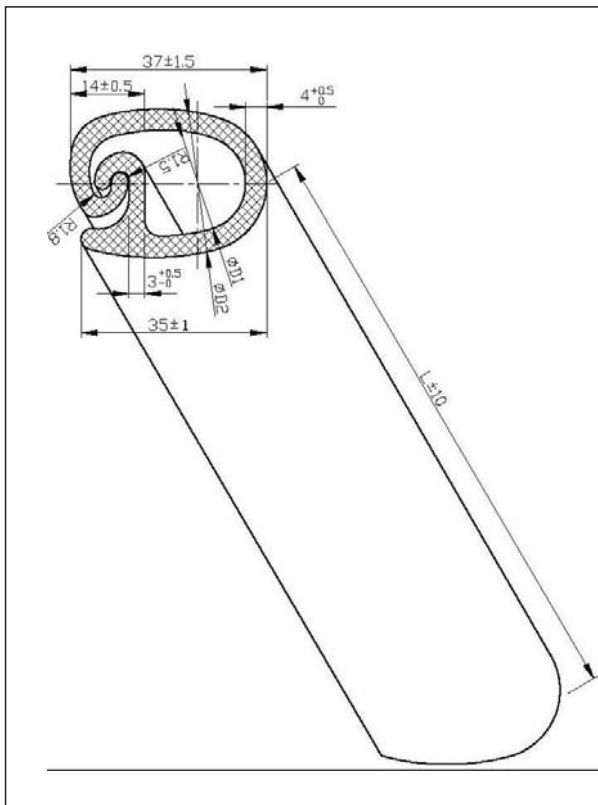



Type: PGA-1



Type: PGA-2



Type: PGA-3

Insulating Protection cover

1. The insulating cover is used for high voltage overhead line protection.

Technical parameters

Item	Test method	Test result	Unit
Physical properties			
Density	/	1.25	g/cm
Hardness	/	Shore 89	/
Elongation at tear	/	530	%
Tensile strength	/	10.4	Mpa
Longitudinal shrinkage	/	2.5	%
Shrink ratio	/	2.5	%
Thermal properties			
Operating temperature range	/	40100	/
Shrinking temperature	/	125	/
Burning behavior	≥25	31	/
Thermal aging(168h/150)			
Elongation at tear	≥300	593	%
Tensile strength	≥10.4	12.58	Mpa
Electric properties			
Electric strength(23)	≥15	23	kV/mm
Tracking	≥1A3.5	3.6	/
Chemical properties			
Water absorbtion	≤0.5	0.2	%
UV resistance	/	anti-UV light	/
Resistance to fungus and decay	/	anti-corrision	/

AMPLETEK Cable accessories - Medium Voltage

▶ 12-24kV 630A Screen Top bus-bar system



Type: AST-15(24)/630
Screen Crossing connector



Type: ADT-15(24)/630
Screen Bus-bar connector



Type: AMG-15(24)/630
Screen bus-bar



Type: ARWMG-15/630/□+75

1. Europe-style crossing connector and bus-bar connector are suitable for ABB, Siemens, Driescher, etc brand.
2. The top or the bottom of switch ring main unit are fully-insulated, fully-submersible, fully-screened.
3. Its fully-insulated and fully-sealed connection avoids the critical defects caused by exposed high voltage in bad weather.
4. The ring main unit consists of crossing connector and bus-bar connector.
5. With high reliability and low investment.

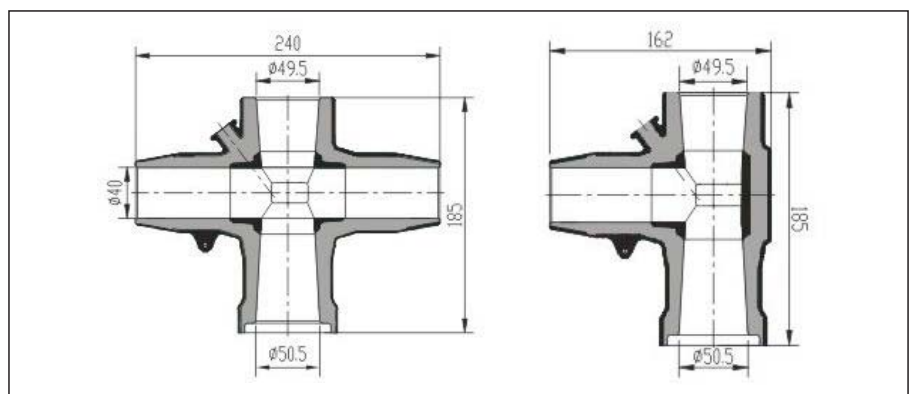
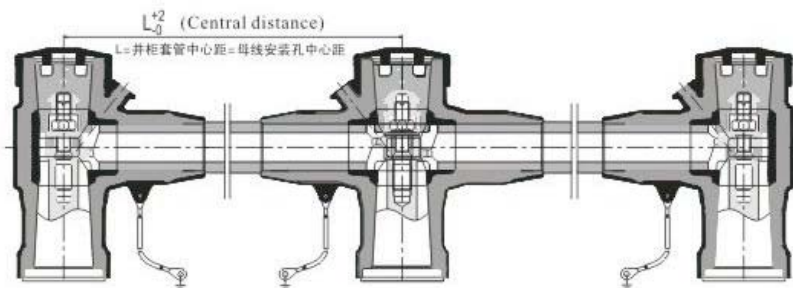

Note: The actual length shall be decided by customers' request

1. The bus-bar assembled with 630A crossing connector and bus-bar connector mounting to the switch socket, it can provide series connection among multiple loaded switch gears.
2. A superior selection to combined RMU.
3. The length of bus-bar for IEC/IEEE crossing connector and bus-bar connector can be decided by customers.

AMPLETEK Cable accessories - Medium Voltage

▶ 10kV 1250A Screen Top bus-bar system



Type: AST-10/1250A
Screen Crossing connector



Type: ADT-10/1250A
Screen Bus-bar connector



Type: AMG-10/1250A
Screen bus-bar

1. Europe-style crossing connector and bus-bar connector are suitable for ABB, Siemens, Driescher, etc brand.
2. The top or the bottom of switch ring main unit are fully-insulated, fully-submersible, fully-screened.
3. It can be used in cable branch box matching with the loaded switch socket.
4. Its fully-insulated and fully-sealed connection avoids the critical defects caused by exposed high voltage in bad weather.
5. The ring main unit consists of crossing connector and bus-bar connector.

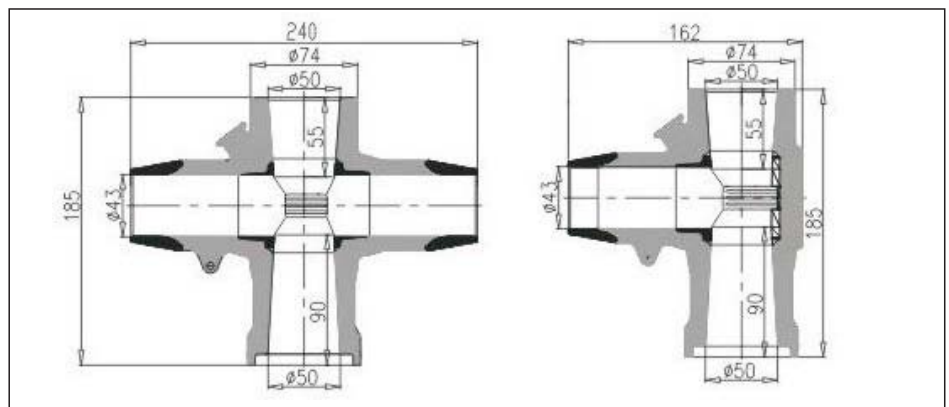
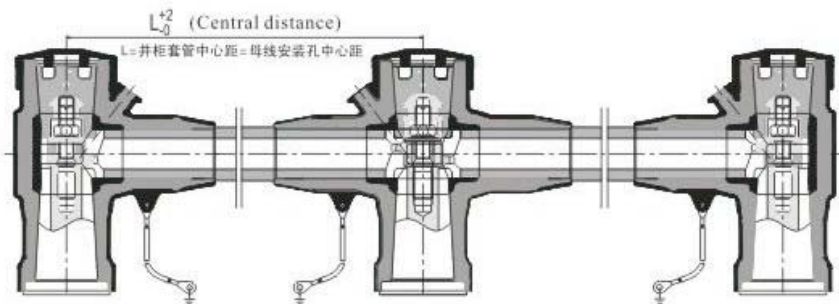

1. The bus-bar assembled with 1250A crossing connector and bus-bar connector mounting to the switch socket, it can provide series connection among multiple loaded switch gears.
2. A superior selection to combined RMU.
3. The length of bus-bar for IEC/IEEE crossing connector and bus-bar connector can be decided by customers.



Note: The actual length shall be decided by customers' request

▶ 35kV Type F bus-bar System



Type: AFD-35-□
F bus-bar connector

1. Suitable for the busbar connecting between 35kV GIS system switchgears.
2. The minimum center distance is 500mm.
3. The contact spring with high conductive beryllium bronze can meet the current 1250A ,2000A,2500A .
4. F busbar system adopt the bolt crimping structure.

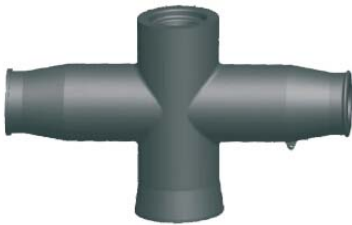

Type: AFS-35- □
F crossing connector

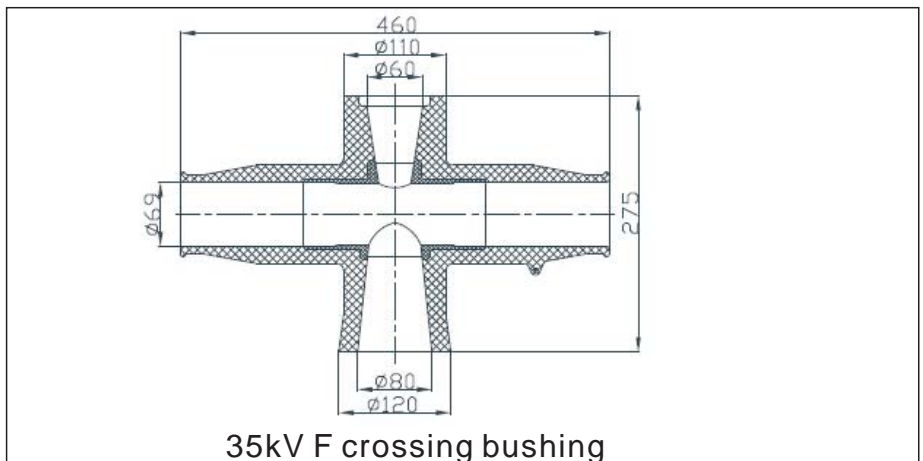
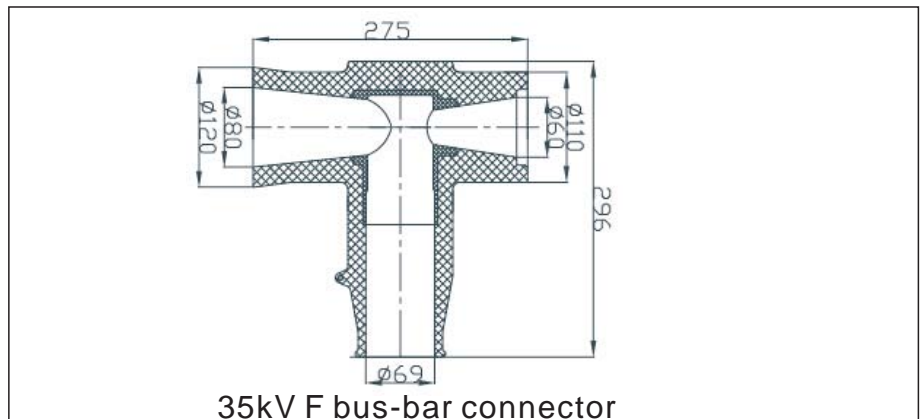

Type: AFTG-35-□
F Bushing

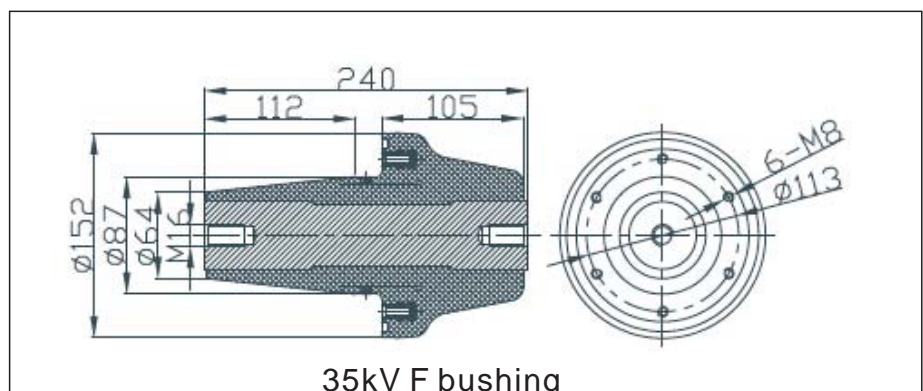

AMPLETEK Cable accessories - Medium Voltage

► 15kV Un-screen Top bus-bar connector



Type: AFST-15/630
Un-screen crossing connector

1. Un-screen crossing connector and bus-bar connector are suitable for ABB, Siemens, Driescher, etc brand. the switchgear cabinet. Matched with standard socket of the load break, also used for branch unit with switch.

2. Its fully-insulated and fully-sealed connection for the load break switch avoids the critical defects caused by exposed high voltage ..

3. With high reliability and low investment.

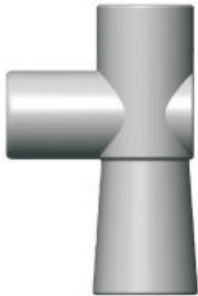

Type: AFDT-15/630
Un-screen bus-bar connector

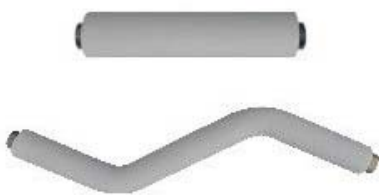
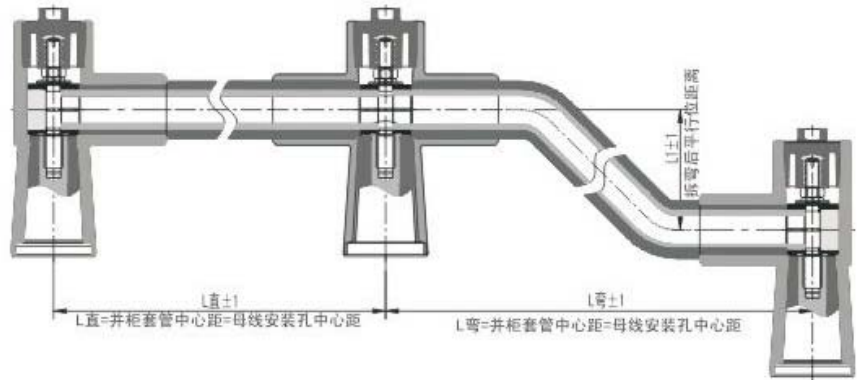

Type: A(W)GM-15/630
Un-screen bus-bar

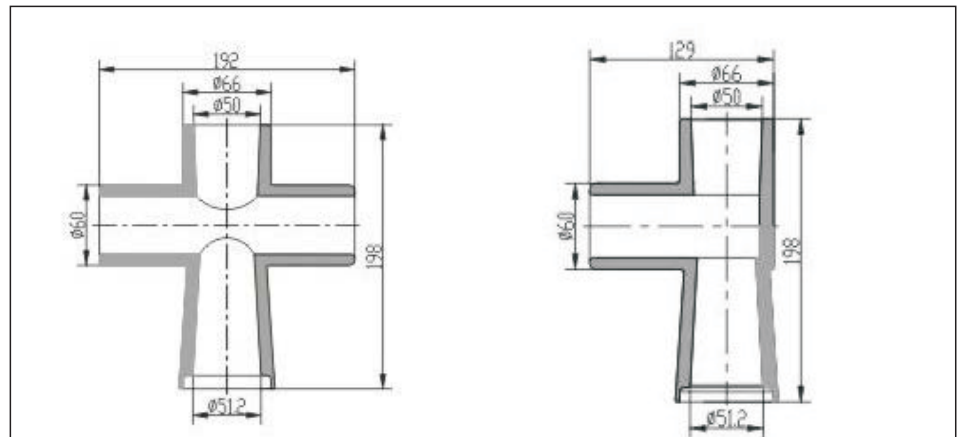

1. The straight and bend bus-bar combined with un-screened crossing connector, bus-bar connector and installed on the socket of the switch.
2. It can be assembled by any position. It not only can save more zone, but also can realize tandem connection for several sets of the load switch. It is an perfect option for combine type ring main unit.
3. The length of the straight and bend bus-bar can be according to the customers' requirements.

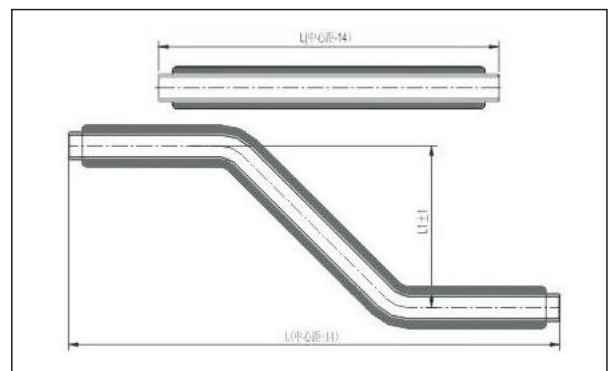

Note: The virtual length can be decided by customers' request.

▶ 15kV 630A Solid switch flexible bus-bar system



Type: ACST-15/630
Long crossing connector



Type: ACDT-15/630
Long bus-bar connector



Type: AZJT-15/630
Screen short right-angle tee



Type: ARWVG-15/630/□+75
Flexible screen bus-bar

Flexible bus-bar system

1. 15kV flexible bus-bar system is include screened(long) crossing connector, (long) bus-bar connector, short right angle four connects and flexible bus-bar. Suitable for solid insulating and seal type ring main unit, solid vacuum switch ring main unit can meet with many kinds of cabinets, also can realize flexible connection, make the cooperate between the cabinet simply.
2. Fully-sealed, fully-insulated, fully-screened connection for the switchgear. And the structure is simple, compact, and use small space, easy for installation and let the cabinet standardize and small scale.

1. The ring main unit is combined by flexible bus-bar system cost low price and more dependable, no installation stress, and can be high tolerance ,easy for installation. It is perfect option for combined type ring main unit.
2. The length of the flexible bus-bar can make according to the customers' requirements.



AMPLETEK Cable accessories - Medium Voltage

▶ Lateral bus-bar system-----Type I



Type: AMLD-15
15kV I plug



Type: AML-15
15kV I Bus-bar connector



15kV I Bus-bar socket

1. I type plug/ bus-bar connector is suitable for the consolidation connection of ring main unit.
2. Supply more branches for expansion.
3. A prior option to combined ring main units.
4. I type bus-bar socket is applying to 10kV electrical system, when the lateral side of the ring main unit to be extension and be more branches combined cabinets, it is used for the port of the bus-bar , it is designed tightly and easy for installation.
5. I type is suitable for Ormazabal, Tianning, Huostone, Zhengchao etc brand.

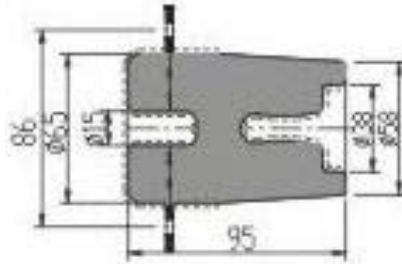

15kV I plug

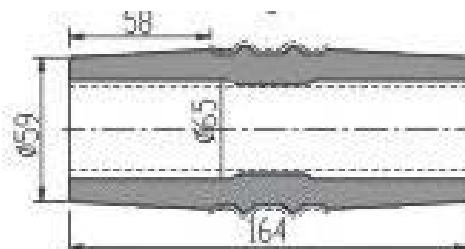

15kV I Bus-bar connector

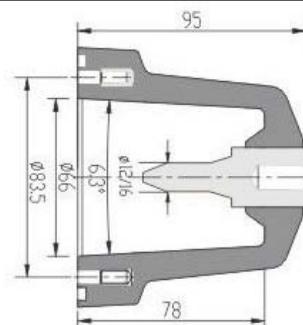

15kV I Bus-bar socket

▶ Lateral bus-bar system-----Type II



Type: AMLD-24
15-24kV II plug



Type: AML-24
15-24kV II Bus-bar connector



15-24kV II Bus-bar socket

1. II type plug/ bus-bar connector is suitable for the combined connection of ring main unit.
2. Supply more branches for expansion.
3. A prior option to combined ring main units.
4. II type bus-bar socket is applying to 10kV electrical system, when the lateral side of the ring main unit to be extension and be more branches combined cabinets, it is used for the port of the bus-bar , it is designed tightly and easy for installation.
5. II type is suitable for Alpha, Galaxy dicKON, Cree etc brand.

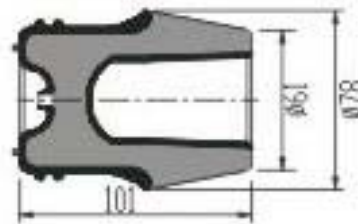

15-24kV II plug

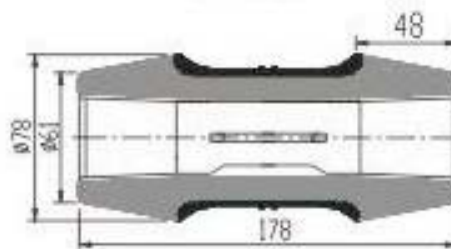

15-24kV II Bus-bar connector

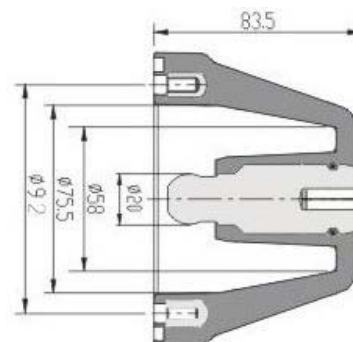

15-24kV II Bus-bar socket

AMPLETEK Cable accessories - Medium Voltage

▶ Lateral bus-bar system-----Typelll



Type: AMLD-15-III
15kV III plug



Type: AML-15-III
15kV III Bus-bar connector



15kV III Bus-bar socket

1. III type plug/ bus-bar connector is suitable for the consolidation connection of ring main unit.
2. Supply more branches for expansion.
3. A prior option to combined ring main units.
4. III type is suitable for Baosheng, Shanguangdian , Huadian etc brand.

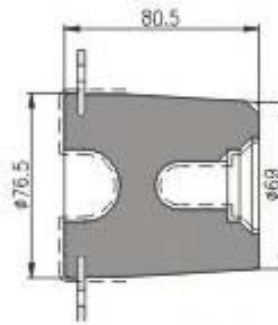

15kV III plug

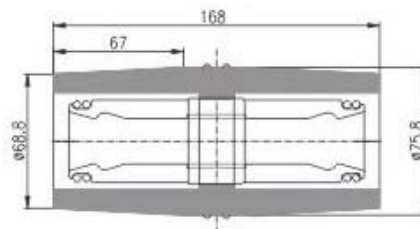

15kV III Bus-bar connector

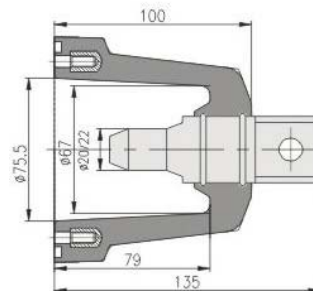

15kV III Bus-bar socket

AMPLETEK Cable accessories - Medium Voltage

► Sf6 Switch Lateral expand soft bus-bar system



Type: AEF 12-24/630A
AEF Flexible cable connector



Type: OM 12-24/630A
OM Flexible cable connector



Type: SLD 12-24/630A
SLD Flexible cable connector

1. The lateral expand soft bus-bar is used for connecting the bus-bar system of inner cone type inflatable ring main unit and measurement device. Easy to install, screened performance well and can match with different sockets of different manufacturers.
2. There is no need for any revolt device to connect the flexible bus-bar connector with termination, and the bend radius is small, and the termination can be open style or fully-closed front or rear connector, PT connector. The lateral bus-bar system can be dismantled and replacable.
3. AEF is suitable for the PT cabinet and measurement cabinet of Alpha, Galaxy, Dickon, Secco sharp etc..
4. OM is suitable for PT cabinet and measurement cabinet of Ormazabal , Tianling, Khodorkovsky, Zhengchao, etc brand.
5. SLD is suitable for PT cabinet and measurement cabinet of Snyder.

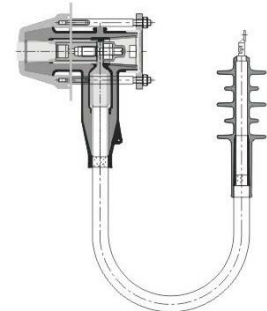
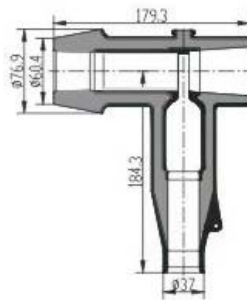

AEF Flexible cable connector



OM Flexible cable connector

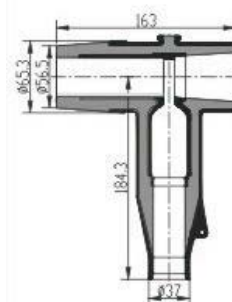

SLD Flexible cable connector

AMPLETEK Cable accessories - Medium Voltage

▶ 12-24kV 630A Straight connector



Type: AZC-12/24/630/□
630A Straight connector

1. Straight connector is suitable for cable branch box, ring main unit and pad-mound transformer etc..
2. The rated current is 630A and rated voltage is 15kV .
3. Apply to 8.7/15kV , 12/20kV XLPE cable.
4. The conductor cross section is 35-300mm .

Characteristics

1. Made of special three layer rubber.
2. Strong tracking resistance and corrosion proof, excellent electric performance and easy for installation.
3. It is international advanced and fully screened product.

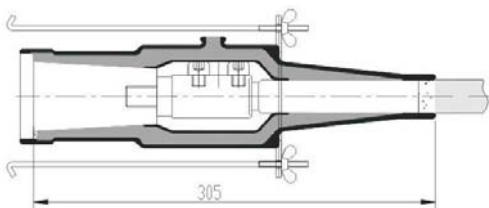

▶ 630A/250A Insulation cap

1. 630A/250A Insulation cap provide insulating protection for energized bushing.
2. It also provides dustproof and moisture proof protection for non-energized bushing.
3. Apply to bushing and multi-junction.
4. If there is spare out-terminator of multi-junction, insulation cap must be sealed.

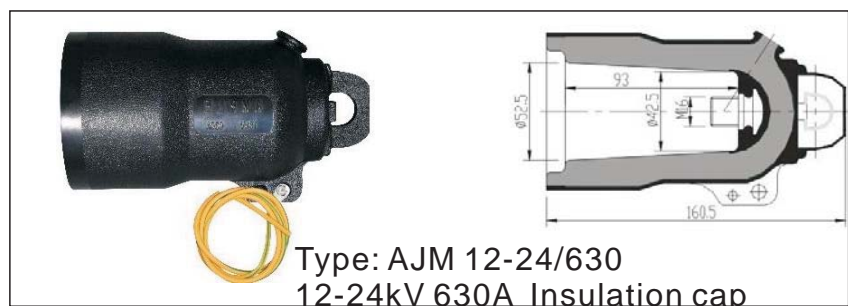
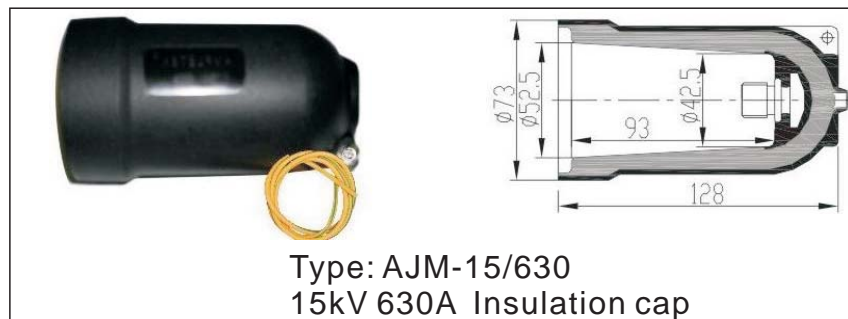

▶ 35kV Screen over-voltage protection surge arrester



1. The most advance in the world.
2. Suitable for at or under 35kV GIS Fully-sealed combination electrics.
3. With the performance characteristics of metal oxide surge arresters.
4. Adopt fully sealed metal shell , touchable , anti-electric shock, safe us.
5. Solid insulated plug-in type assembly, easy use.
6. Excellent organic insulated materials, high dielectric strength.

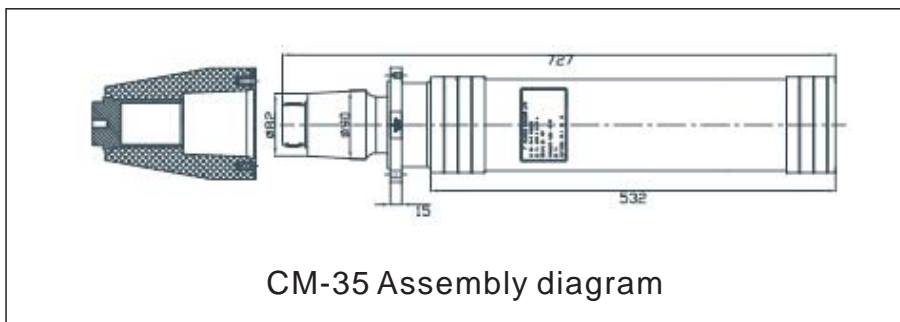

Type: CM-35
Screened over-voltage
protection surge arrester

Performance parameters

Type	Unit	CM-35
System nominal voltage	kV(r.m.s)	35
Rated voltage	kV(r.m.s)	51
Continuous operation voltage	kV(r.m.s)	40.5
At D.C. 1mA voltage U_{1mA}	\geq kV	73
Lightning impulse current residual voltage \leq kV	Steep Lightning Operating	154 134 114
2ms Retangular current withstand	A	400(600)
4/10 μ s High current impulse withstand	kA	65

AMPLETEK Cable accessories - Medium Voltage

▶ 35kV Current Test Device



Type: APCT-2
35kV Current Test Device2#



Type: APCT-2
35kV Current Test Device2#

Suitable for large current test of apparatus with inner cone socket, such as gas insulated switch and transformer etc. Put the product into the homologous socket and the test wire connect to the bolt of the product when do the test.

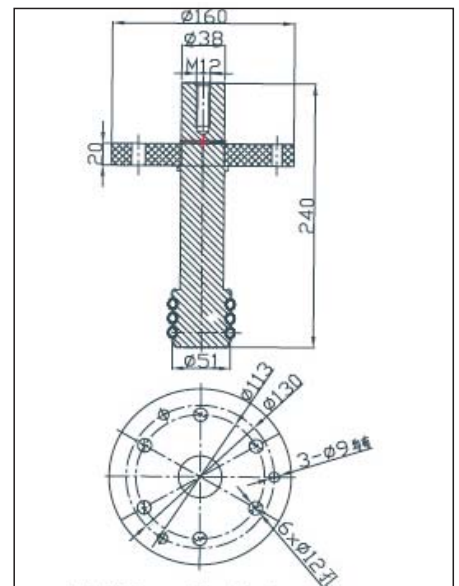
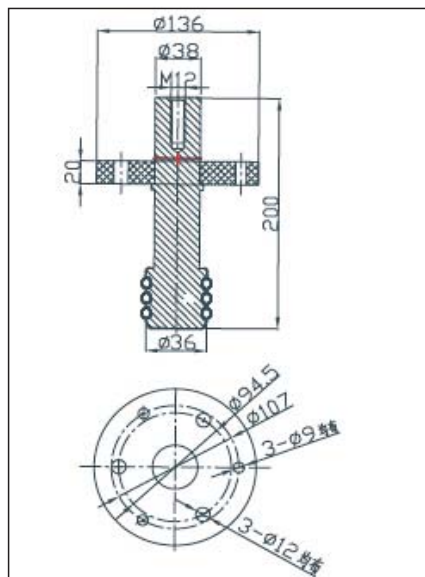

▶ 35kV Voltage Test Socket

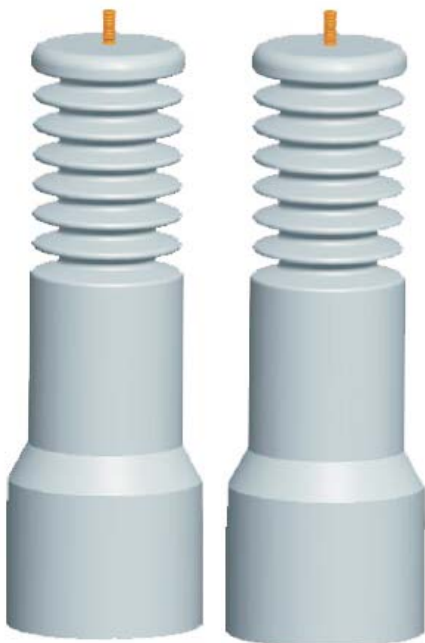

Type: APVT-2 Type: APVT-3
35k Voltage 35k Voltage Test
Test Socket2# Socket3#

Apply to electrical test for the cable with inner cone plug-in termination.

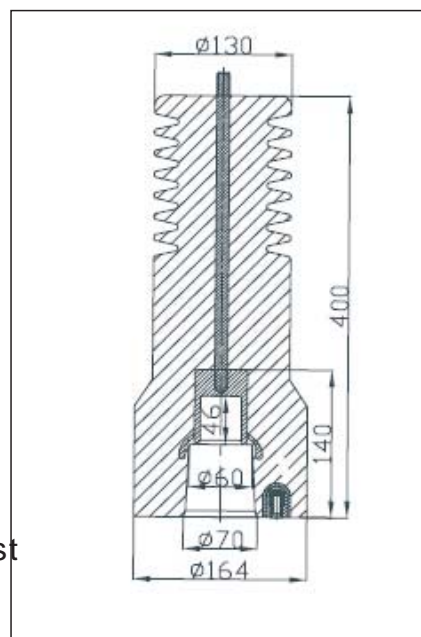

2#

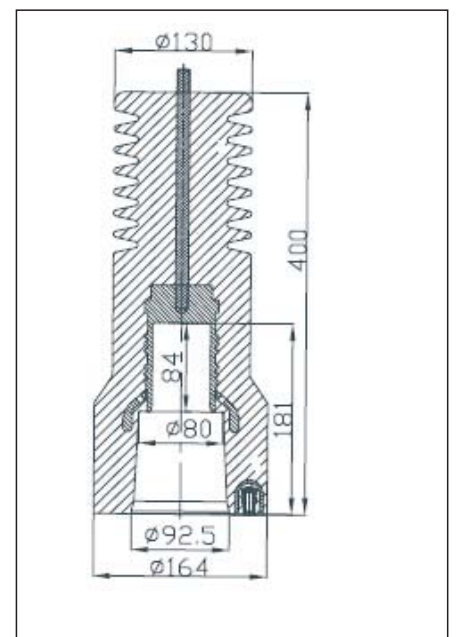

3#

AMPLETEK Cable accessories - Medium Voltage



Type: APCV-3
35kV Energized
Protection Cap

▶ 35kV Energized Protection cap

35kV Energized protection cap protects the energized inner cone plug-in termination against electric shock. It also can be used for the withstand voltage test of test cable.



Type: APC-3
35kV Non-energized
Protection Cap

▶ 35kV Non-energized Protection cap

1. It provides dustproof and moistureproof protection for inner cone plug-in termination.
2. It cannot withstand the voltage.

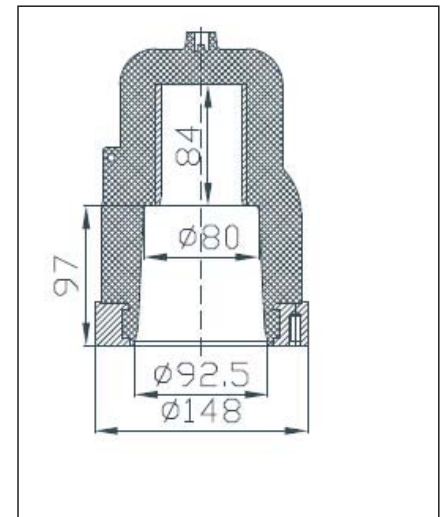
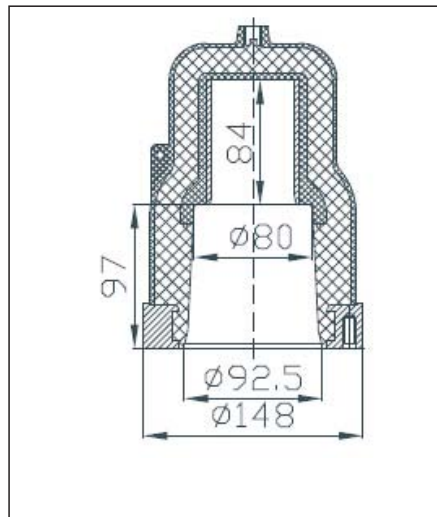

Type: AWSY35-□
35kV Test cable

▶ 35kV Test cable

Suitable for electric performance test of apparatus with inner cone socket, such as gas insulated switch and transformer etc. And it can be used repeatedly.

Standard :GB/T12706.4-2002 IEC 60502-4
Technical parameters:

Power frequency withstand voltage: 117kV/5mins
Partial discharge:45kV (<10pC)

▶ 35kV Inner cone plug-in termination



Type: ACBN-26/35 / □
26/35kV Inner cone plug-in termination



Type: ACBN-1#/2#/□
1#/2# Inner cone plug-in termination

1. Has outstanding advantages in high voltage system.
2. Easy for installation.
3. Test software is more economic and safe.
4. The plug-in system avoids the complex working for thread gas treatment and insulation oil treatment.

Characteristics

1. According to standard IEC60859, it can save 50% mounting space compared with traditional termination system.
2. No need to re-open the cable store, thus reducing much work for dealing with gas and insulation oil.
3. Can be connected with transformer or GIS horizontally, vertically or in any different angle.
4. Greatly increased its security and economy after the use of factory testing pre-assembled components.
5. Reduce the installation mistake to the minimum degree.
6. The cable and apparatus will separate immediately once there is fault in system.

1. Inner cone socket
2. Bolt
3. Spring
4. Contacting ring
5. Pressure ring
6. Cable adaptor
7. Plastic bushing
8. Bushing seal ring
9. Metal sheath seal ring
10. Metal sheath
11. Compression spring
12. Cable
13. Conjunction piece
14. Tube
15. Protection cover

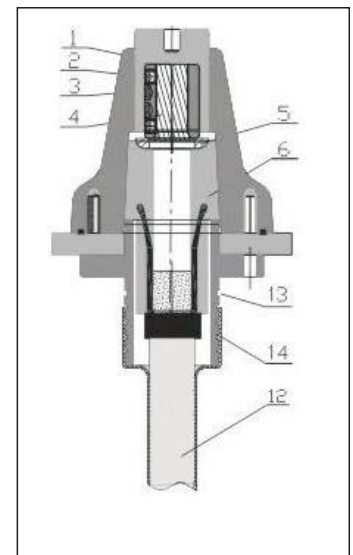
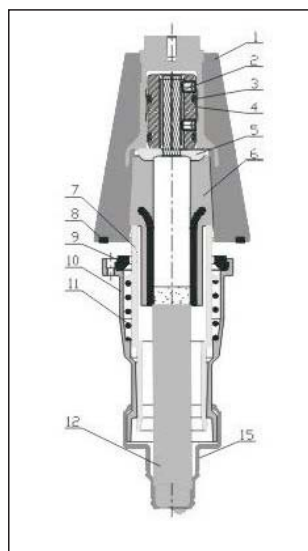

▶ 35kV Inner cone socket

1. Suitable for incoming connecting of GIS high-voltage unit and with insulation performance for SF6 unit.
2. Suitable for indoor & outdoor application.
3. Fully insulated and free of maintenance.
4. The connection size is compliant to DIN47637 standard.



Type: ANC-1
1# Inner cone socket

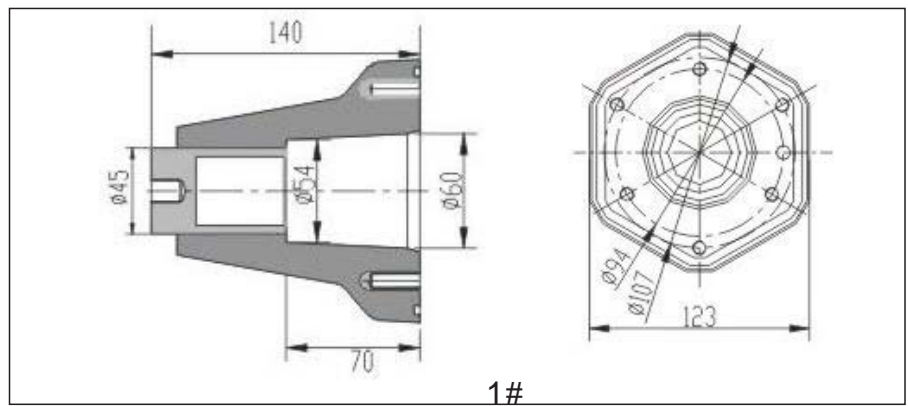

1#



Type: ANC-2
2# Inner cone socket

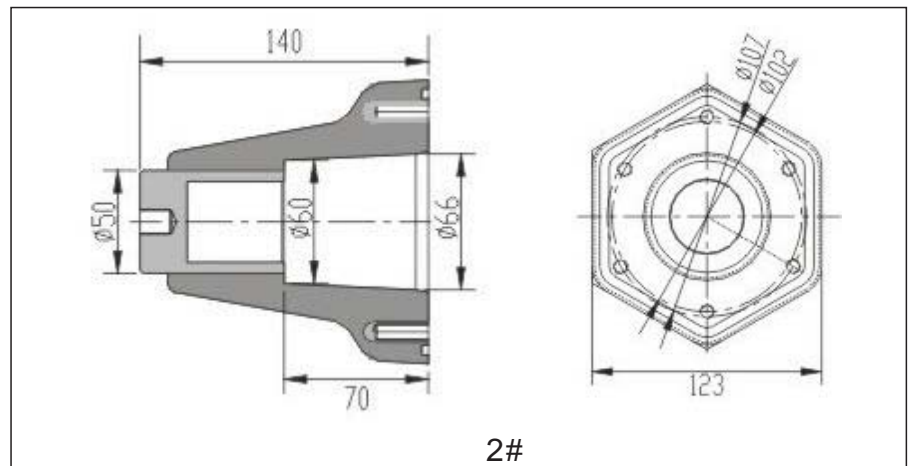

2#



Type: ANC-3
3# Inner cone socket

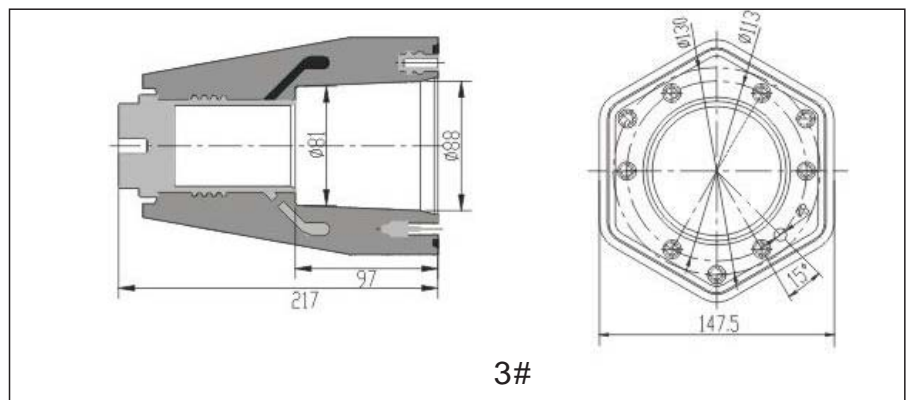

3#

▶ 35kV PT connector

1. 35kV PT connector is used to provide sealed transition parts for the connection between 1# / 2# inner cone socket and voltage mutual inductor.
2. Product performance is in accordance with IEC60502 standard.



Type: APT-35-1
PT plug

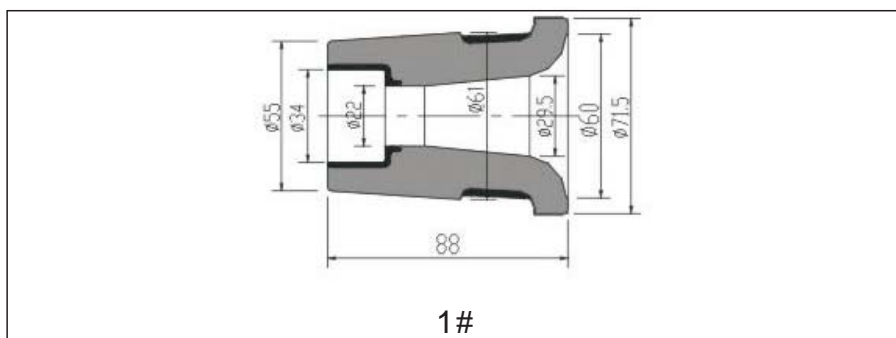

Type: APT-35-2
PT plug

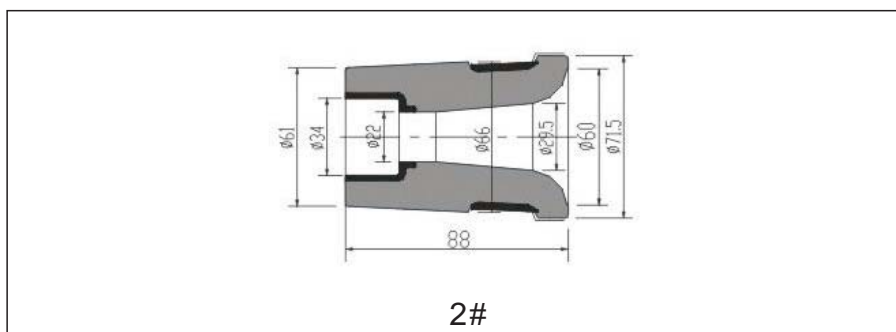

Type: APT-DYH2.1
Voltage transformer
connector

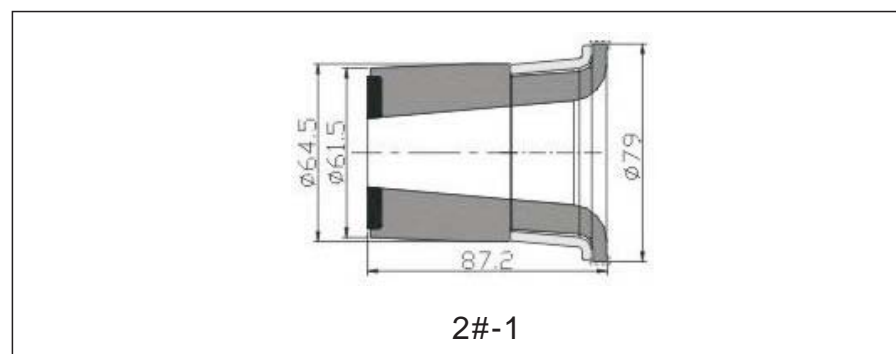

Type: APT-DYH2.2
Voltage transformer
connector

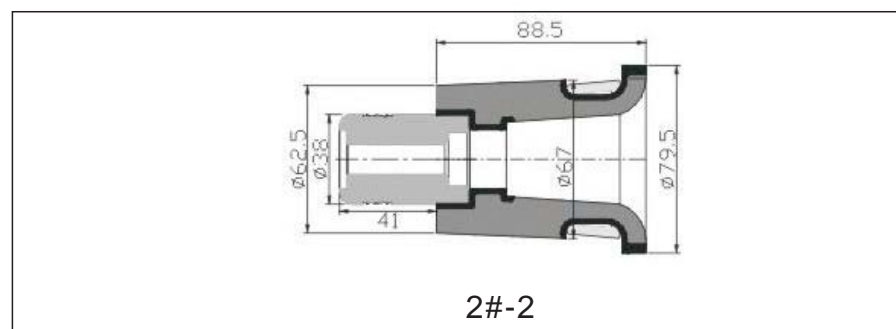

▶ 35kV Top-end

1. 35kV Top-end provide insulating protection for 35kV ring main unit.
2. The spare outgoing line should be sealed by 35kV top-end.
3. 1#,2#,3# inner cone top-end is respectively suitable for 35kV 1# , 2#, 3# Inner cone socket. 1#-1, 1#-2 top-end is suitable for 35kV transformer.

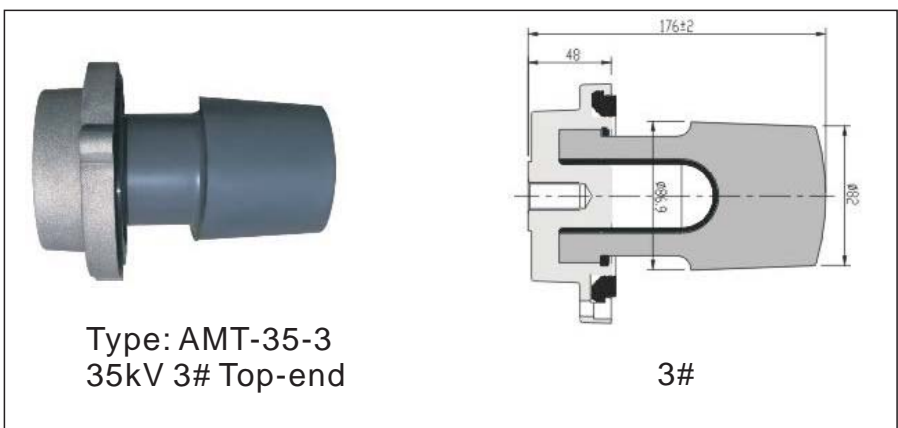
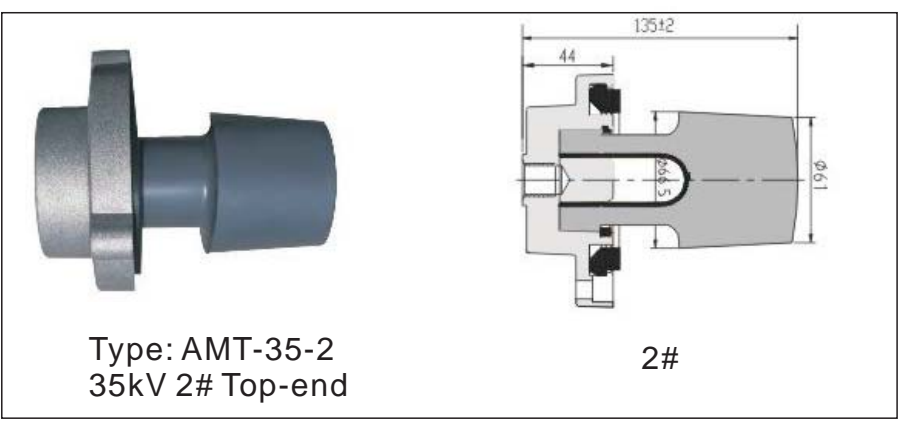
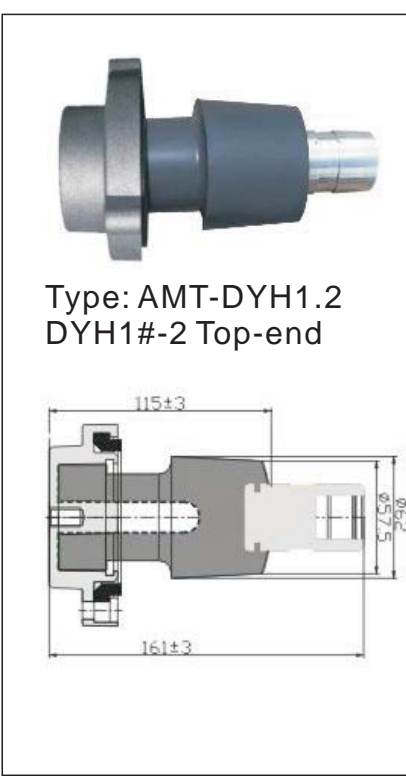
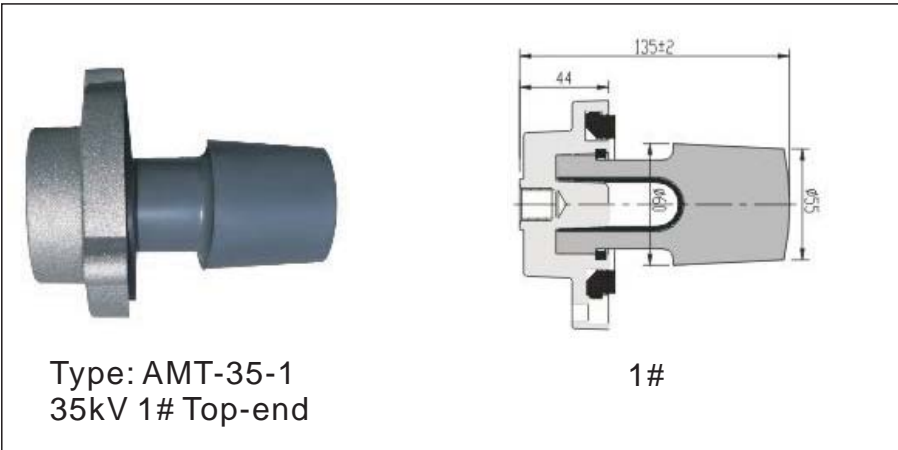
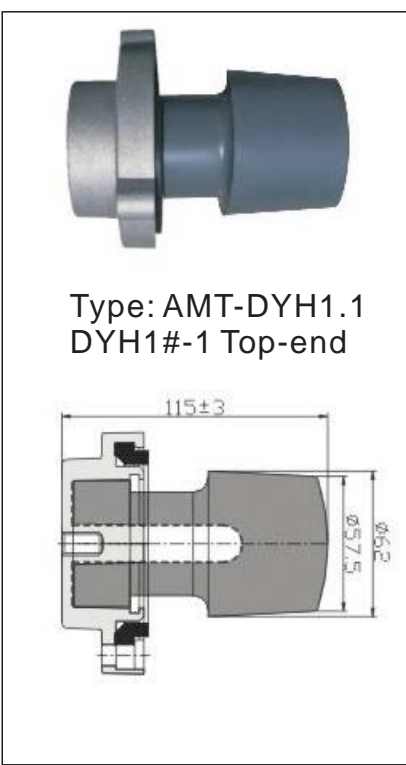

▶ 35kV I-type lateral system

1. 35kV Insulating plug is suitable for expandable ring main unit.
2. Provide insulation, dustproof and dampproof protection for non-expanding ring main unit.
3. 35kV bus bar connector is suitable for the combination of 35kV GIS system.
4. Compact structure and high current capacity.
5. It is the prior option to 35kV combined ring main unit.



Type: AMXNZ-35-I
I type bus-bar socket

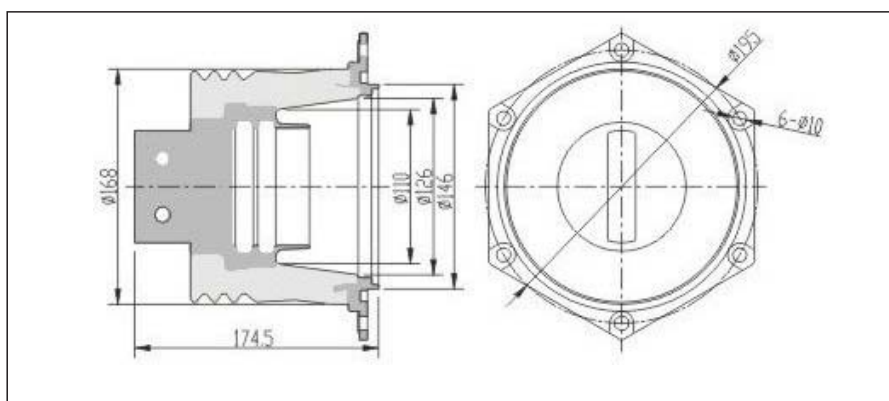

Type: AMLD-35-I
I type plug

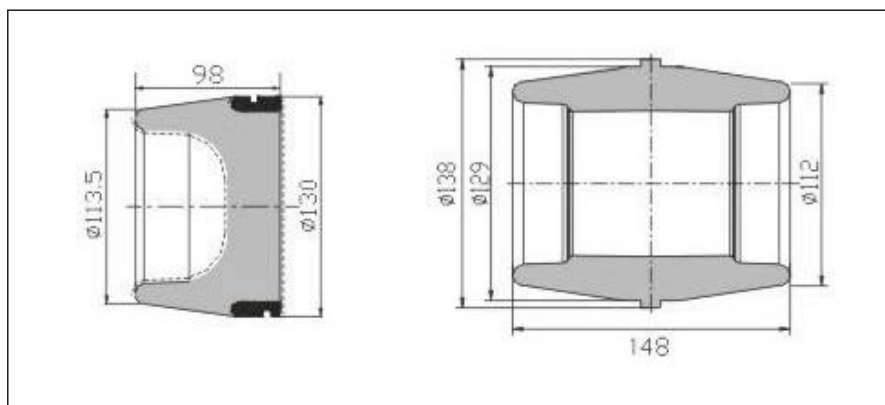

Type: AML-35-I
I type bus bar connector

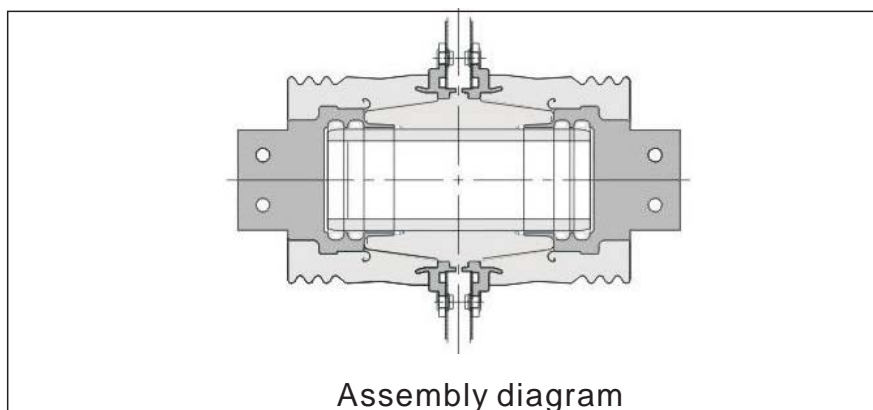

▶ 35kV II-type lateral bus-bar system

1. Adopt the latest technology of consolidation cabinets.
2. Built-insulator fixed installation is more convenient, faster, and with higher electrical performance.

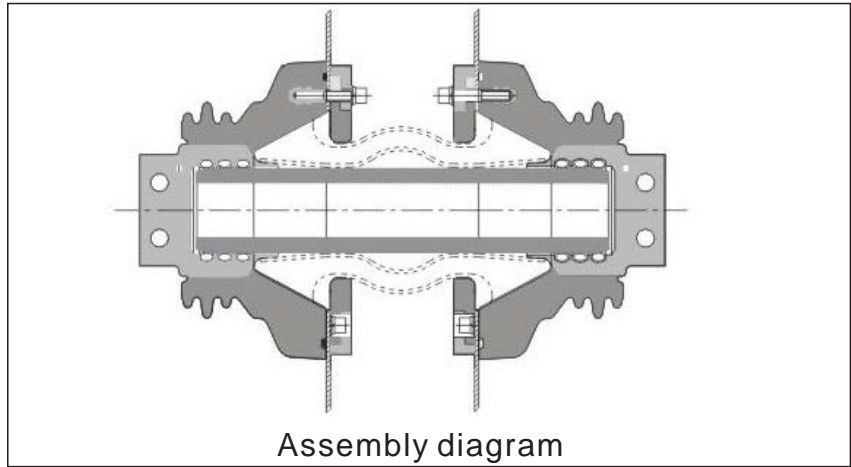

Type: AMXNZ-35-II
II type bus-bar socket

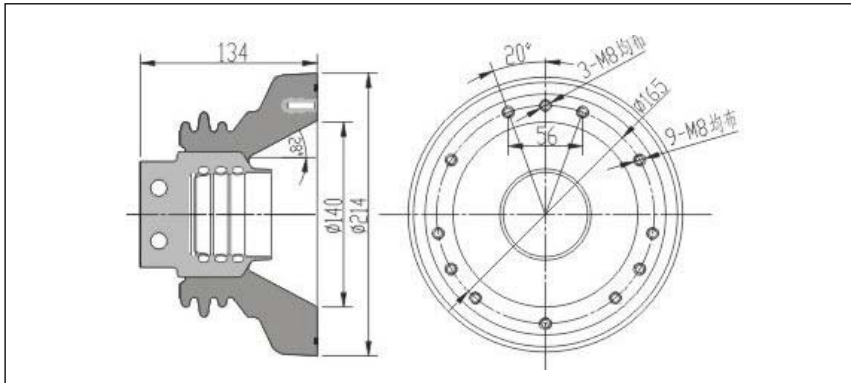

Type: AMLD-35-II
II type plug

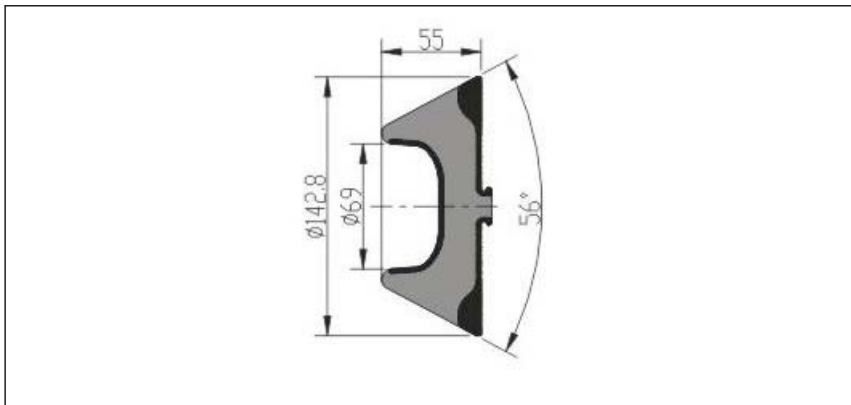

Type: AML-35-II
II type bus bar connector

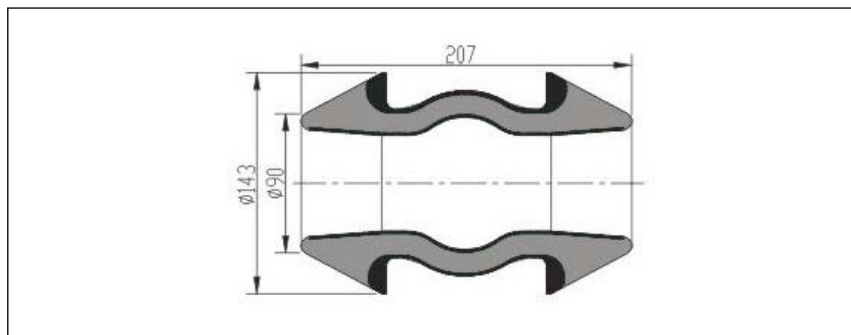

► 15-24kV Insulation test stick

1. 15-24kV insulation test stick is mainly used for leading into high voltage for the withstand voltage inspection in cable accessories test.
2. Do the withstand voltage test for the accessories according to the related standard.



15kV 1# / 2# Insulation test stick

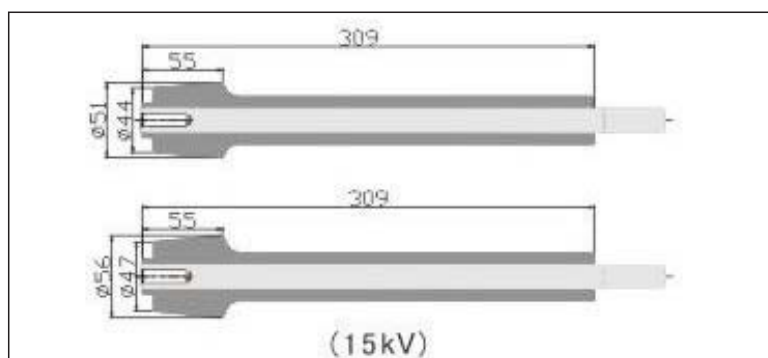

24kV Insulation test stick

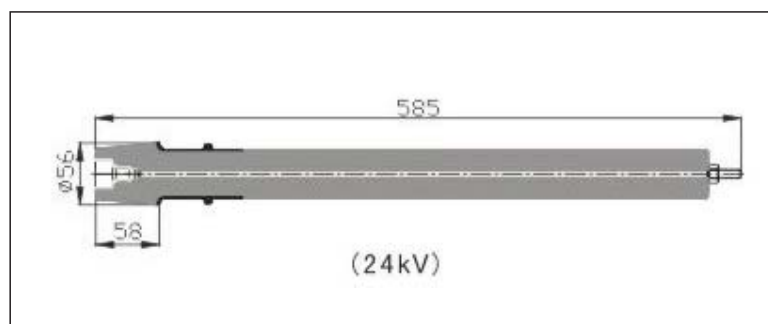

► Bypass cable wire

1. Bypass cable wire is used for the maintenance of high voltage transmission line on the column.
2. Provide temporary power supply to meet users' electricity demand.
3. Safe and reliable.



Bypass cable download

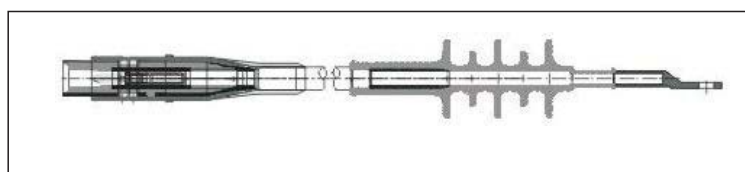

AMPLETEK Cable accessories - Medium Voltage



Type: ANSY35-1
Inner cone testing pole

▶ 35kV Inner cone testing pole

1. Apply to high voltage connecting or GIS test system grounding.
2. It is the substitute of test power cable and can be used repeatedly.



Type: ANSY35-3
Test cable

▶ 35kV Test cable

1. Suitable for electric performance test of apparatus with inner cone socket, such as gas insulated switch and transformer, etc..
2. It can be used repeatedly.
3. Meet to standard GB/T12706.4-2002 , IEC60502-4
4. Technical parameters:
 - . Power frequency withstand voltage: 117kV/5mins
 - . Partial discharge: 45kV < 10pC



Type: ACBN-35R
35kV Fusegear connector

▶ 35kV Fusegear connector

1. It is a transition sealed insulation product, applying to the oral position of the fuse protector.

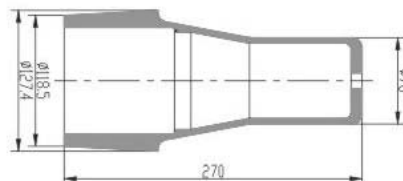

Type: AZCS-15/250K
Straight connector test clamps



Type: AZCS-15/630K
Straight connector test clamps

▶ Test clamps

1. 250A/630A test clamps is suitable for 15kV electrical system, applying to the electric performance test for gas insulated switch ,transformer ,etc.. distribution system.
2. Reliable power supply ensures the electric net to operate well.