

AMPLETEK Cable accessories - Medium Voltage

▶ 35kV PT connector

1. 35kV PT connector is used to provide sealed transition parts for the connection between 1# / 2# inner cone socket and voltage mutual inductor.
2. Product performance is in accordance with IEC60502 standard.



Type: APT-35-1
PT plug

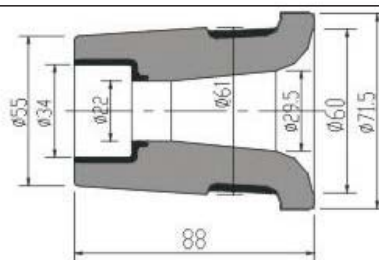

1#



Type: APT-35-2
PT plug

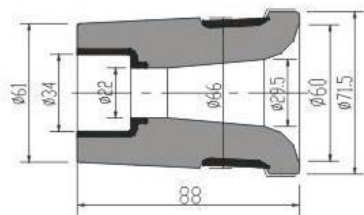

2#



Type: APT-DYH2.1
Voltage transformer
connector

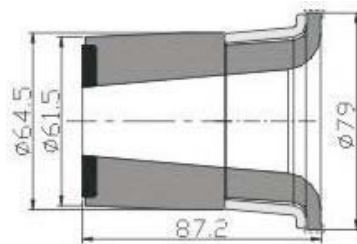

2#-1



Type: APT-DYH2.2
Voltage transformer
connector

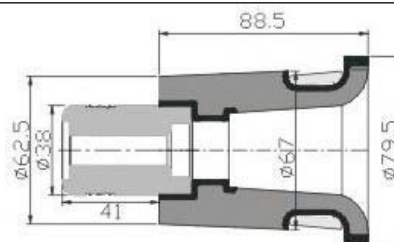

2#-2