

顶部母线系统

Top bus-bar system

屏蔽母线系统

欧式十字接头、丁字接头适用于ABB, 西门子, 德理施尔等品牌; 环网柜开关的顶部或底部全绝缘、全密封连接, 有屏蔽与非屏蔽两种。与负荷开关标准插座匹配, 也用于带开关分支箱中。

对负荷开关实现了全密封、全绝缘连接。完全避免了高压裸露在恶劣天气下所带来的致命缺陷。用十字接头、丁字接头母线系统组合成的环网柜造价低、可靠性高。

Screen bus-bar system

1. Europe-style crossing connector and bus-bar connector are suitable for ABB, SIEMENS, Driescher, etc brand. the top or the bottom of switch ring main unit.
2. Fully-insulated, fully-submersible, screened and un-screened product.
3. Can be used in cable branch box matching with the loaded switch socket.
4. Its fully-insulated and fully-sealed connection avoids the critical defects caused by exposed high voltage in bad weather.
5. The ring main unit consisting of crossing connector and bus-bar connector.
6. Has high reliability and low investment.



Type: AST-15/630A
(十字接头)
(Crossing connector)



Type: ADT-15/630A
(丁字接头)
(Bus-bar connector)



Type: AMG-15/630A
(偏位屏蔽母线)
(Screen bus-bar)



Type: AMG-15/630A
(偏位空心屏蔽母线)
(Hollow screen bus-bar)

母线与630A十字接头、丁字接头组合, 安装在开关的插座上。可实现多台负荷开关的串接。是组合型环网柜的优选方案。

欧式十字接头、丁字接头配套母线长度可根据客户要求任意定制。

1. The bus-bar assembled with 630A crossing connector and bus-bar connector mounting to the switch socket, it can provide series connection among multiple loaded switch gears.
2. A superior selection to combined ring main unit.
3. The length of bus-bar for Europe-style/American-style crossing connector and bus-bar connector can be decided by customers.

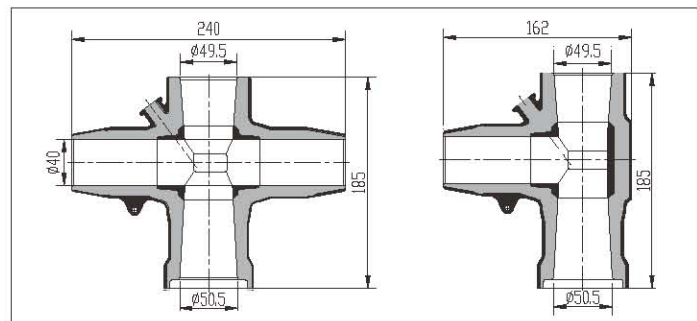
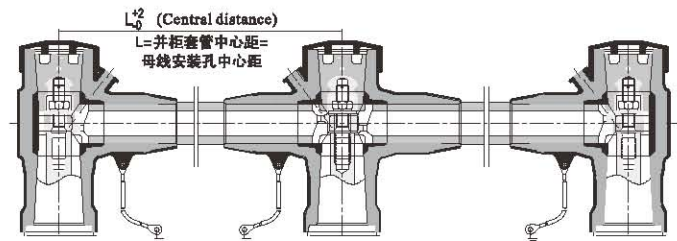

(屏蔽型十字接头)
(Screen crossing connector)

(屏蔽型丁字接头)
(Screen separable bus-bar connector)

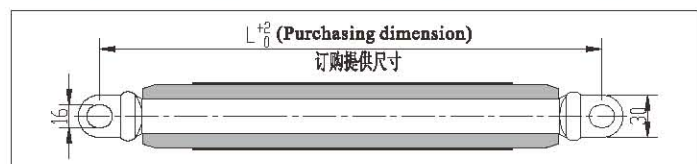

(注: 实际长度可根据客户要求定制)
(Not: the virtual length call be decided by customers' request)